

Panel Repair Station R5

Meet the game changer –

The first fully automated panel repair station

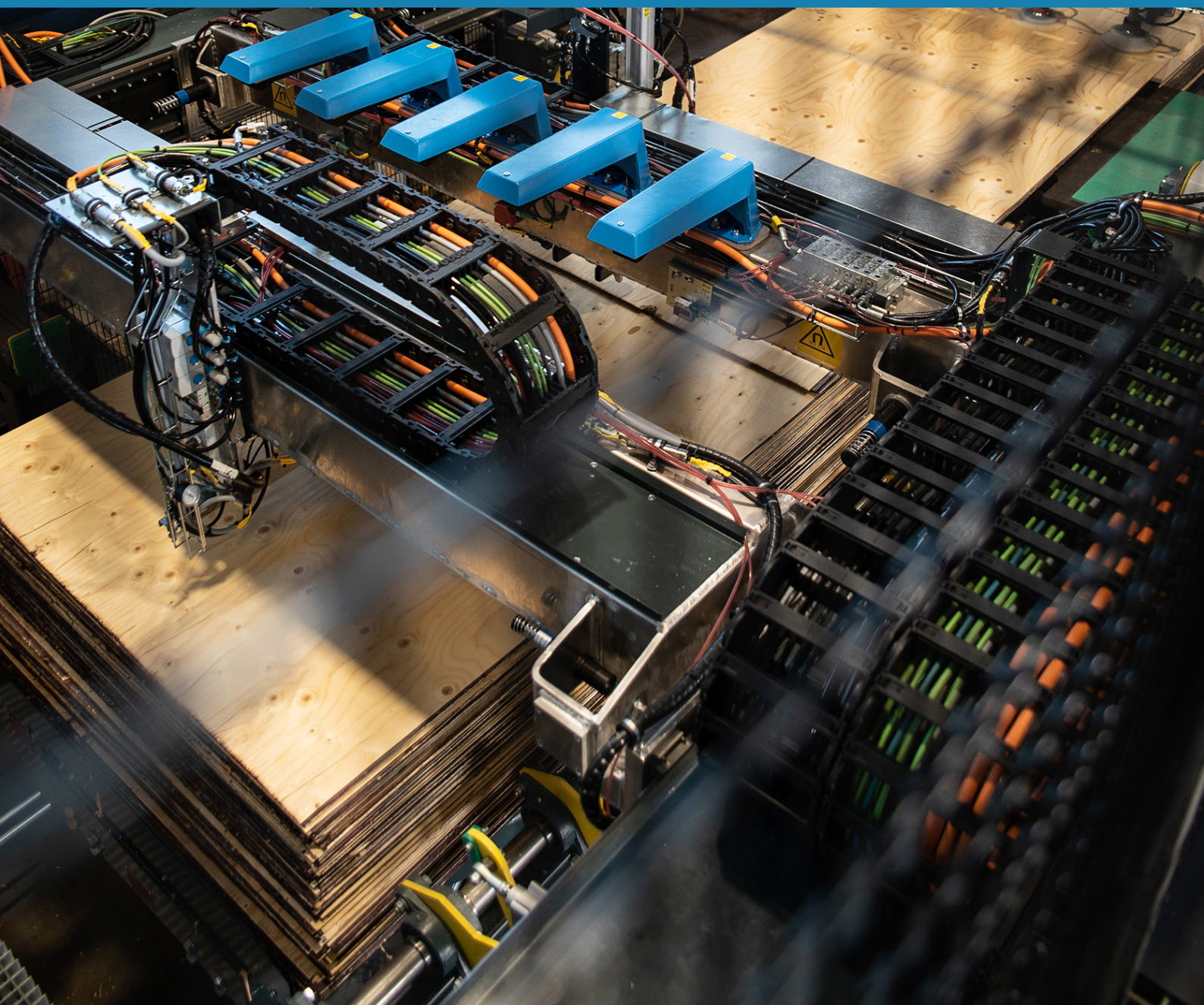

WHAT IS PANEL REPAIR STATION

Raute Panel Repair Station R5 automates the panel repairing process by repairing panels directly in stack on the top most panel while moving repaired panels individually to the next stack. Panel repairing process using Raute Panel Repair Station R5 is more cost efficient by significantly reducing work hours and repair material.

FULLY AUTOMATED ADVANTAGE

- Minimum need of floor space, takes 8x10m and no need for foundations
- Up and running within two weeks from the delivery
- Stack of 100 panels repaired at once
- Fully automatized process
- True one-man-operation
- Superior end product quality
- Full remote support provided by Raute
- Uniform production quality: PA, PSI, EN, ISO, Ghost, JAS, ANZ, SFS
- 100% test driven before delivery
- Minimal need of maintenance: automatically lubricates linear motor bearings and linear motors have no moving parts
- Minimal need of monitoring: fork lift driver can monitor while moving stacks

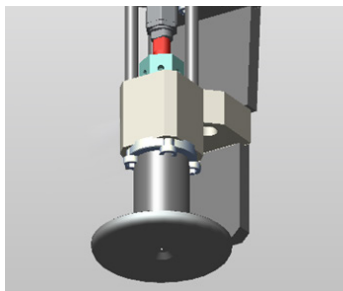

Putty



Router



Synthetic

TECHNICAL DATA

ROUTER

Blade diameter	20 mm
----------------	-------

PUTTY / POLYURETHANE

Panels per minute	5
Places in curing rack	10
Curing time	120 s

REPAIR AREA

Detects and repairs
dents, holes and
splits

REPAIR TOOLS

- Putty
- Routing
- Synthetic

PANEL MOVERS

Moves repaired panels
one by one.

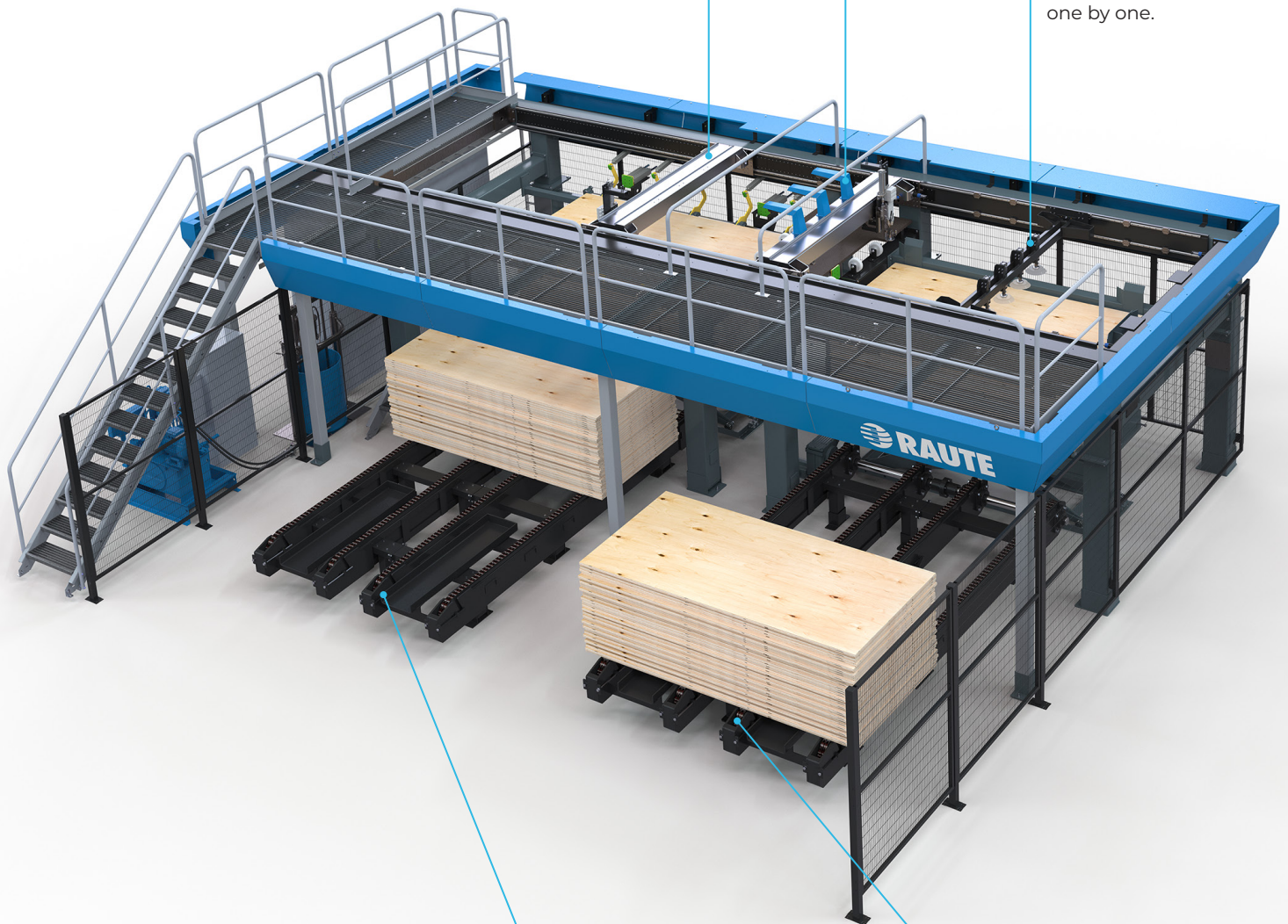

STACK IN

Unrepaired panels stack in

STACK OUT

Repaired panels stack out

BENEFITS

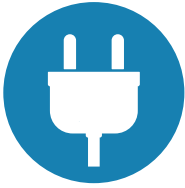

**FAST
INSTALLATION**



**SHORT DELIVERY TIME,
4-6 MONTHS LEAD TIME**



**TAKES ONLY 8X10M
FLOOR SPACE**



**UP TO 20% SAVINGS IN
REPAIR MATERIALS**

DEFECT DETECTION

- Integrated laser cameras take full 3D images of the panel face
- Station defects sizes that are dents, holes and splits and takes into consideration their length, width, depth, volume and number

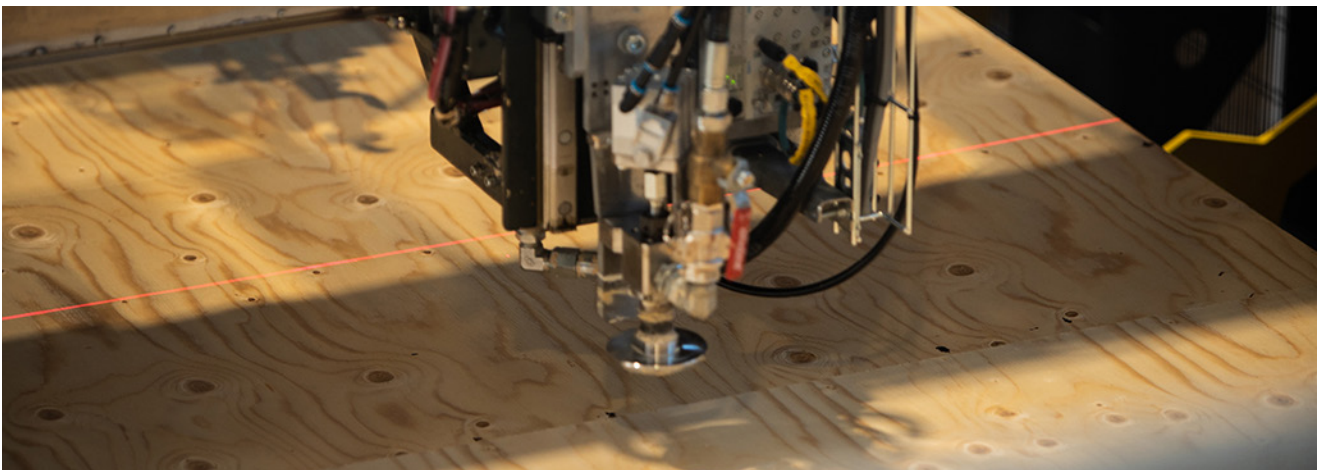

Hole



Split



raute.com

Making wood matter